

Introducing

# PARKWAY

BY PRESTIGE ONE





On your way  
from PARKWAY through DUBAI

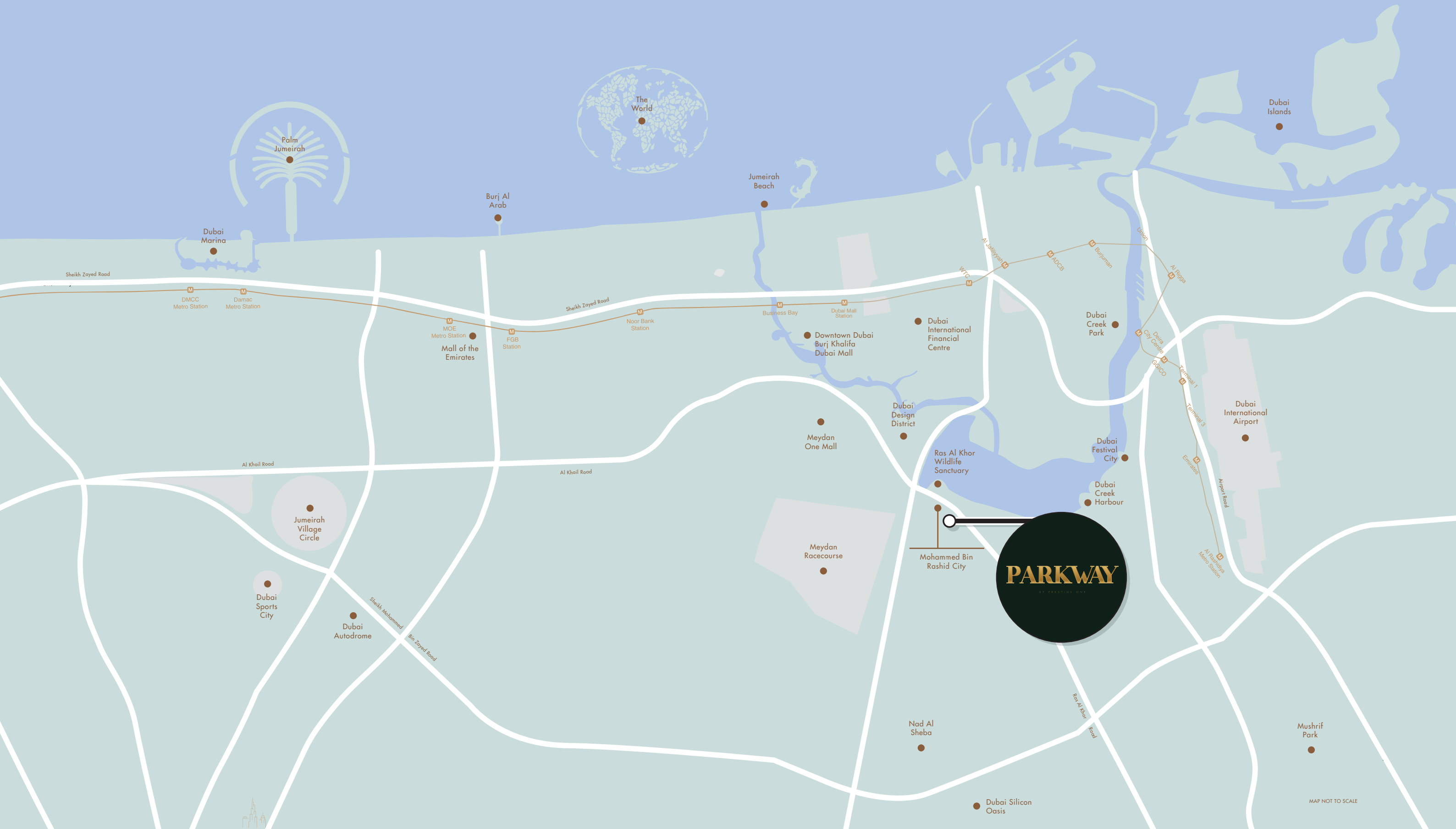





### Mohammed Bin Rashid City

This iconic destination, launched by His Highness Sheikh Mohammed Bin Rashid Al Maktoum, boasts an investment of AED 30 billion and is a vibrant tapestry of lush parks, the world's largest shopping centre, and the biggest man-made lagoon.

MBR City has seen significant development with many new projects continually added. Strategically positioned between Sheikh Mohammed Bin Zayed Road (E311), Sheikh Zayed Road (E11), and Al Khail Road (E44), residents enjoy wide connectivity.

### Meydan Horizon

Meydan Horizon is a cutting-edge mixed-use development forming a part of the grand Mohammed Bin Rashid Al Maktoum City vision.

Spread over an impressive 185.5 hectares, this project offers a panoramic view of Ras Al Khor and encompasses over 39 million sqare feet of developable area.

<b>39M</b>	<b>72K</b>	<b>2KM</b>
SQUARE FEET	FUTURE RESIDENTS	FLOWING CANAL





## Ras Al Khor Wildlife Sanctuary

Ras Al Khor Wildlife Sanctuary is a haven for avian enthusiasts and nature lovers alike.

Nestled at the mouth of Dubai Creek, it offers a serene escape with its lush mangroves, tranquil lagoons, and a host of migratory birds, including the colourful flamingos.



## Dubai Design District (d3)

Dubai Design District (d3) is the epicentre of innovation and creativity where aspiring designers, art aficionados, and fashionistas meet.

This district fosters a community of creative minds that shape the region's design landscape.



## Downtown Dubai

Downtown Dubai stands as a towering testament to modernity.

At the pulsing heart of the city, it hosts the iconic Burj Khalifa, the bustling Dubai Mall, and the mesmerising Dubai Fountain.



## Meydan One Mall

Meydan One Mall is set to redefine luxury shopping and modern retail in Dubai.

With its avant-garde architecture and a vast array of high-end stores, it promises a shopping experience like no other.





---

# Sleek Design, Five-Star Resort Living

Welcome to Parkway by Prestige One, a building defined by modern design and the comfort of resort-style living.

With its fresh, open spaces and a focus on natural surroundings, enjoy a rare experience of calm in the heart of Dubai.







Rooftop

Building Configuration

Ground Floor  
Podium Floors  
32 Residential Floors

Unit Types

1-Bedroom, 2-Bedroom and 3-Bedroom  
apartments

Residences

Size Range per Unit Type

1-Bedroom  
From 724.93 sq. ft. to 1,889.87 sq. ft.

2-Bedroom  
From 1,103.27 sq. ft. to 1,987.07 sq. ft.

3-Bedroom  
From 1,735.95 sq. ft. to 2,026.79 sq. ft.

Number of Units per Type

1-Bedroom - 158 units

2-Bedroom - 88 units

3-Bedroom - 28 units

Podium Floors

Ground Floor



# Premium Features Unique Amenities

## Indoor Amenities



Club Lounge /  
Multi-Purpose Room



Cinema  
Room



Owner's  
Lounge



Games  
Room



Kids'  
Play Area



Gym



Yoga  
Studio



Sauna



Male / Female  
Changing Rooms  
and Toilets





Outdoor Amenities



Kids' Pool



Wet Kids' Play Area



Dry Kids' Play Area



Multi-Sports Court



Mini-Putt Golf



Family Pool



Juice Bar



Adults Pool



Cinema Area



BBQ Area



Open Garden Deck



Games Room

Recreation Perfected

Adding a refreshing dimension to the ambience of PARKWAY with a fun touch of top-tier Arcade Room and premium entertainment, and a different fun and appeal.





Cinema Room

Enjoy an unparalleled movie experience in our indoor cinema,  
that features plush seating and starlit ceiling for the project movie experience.



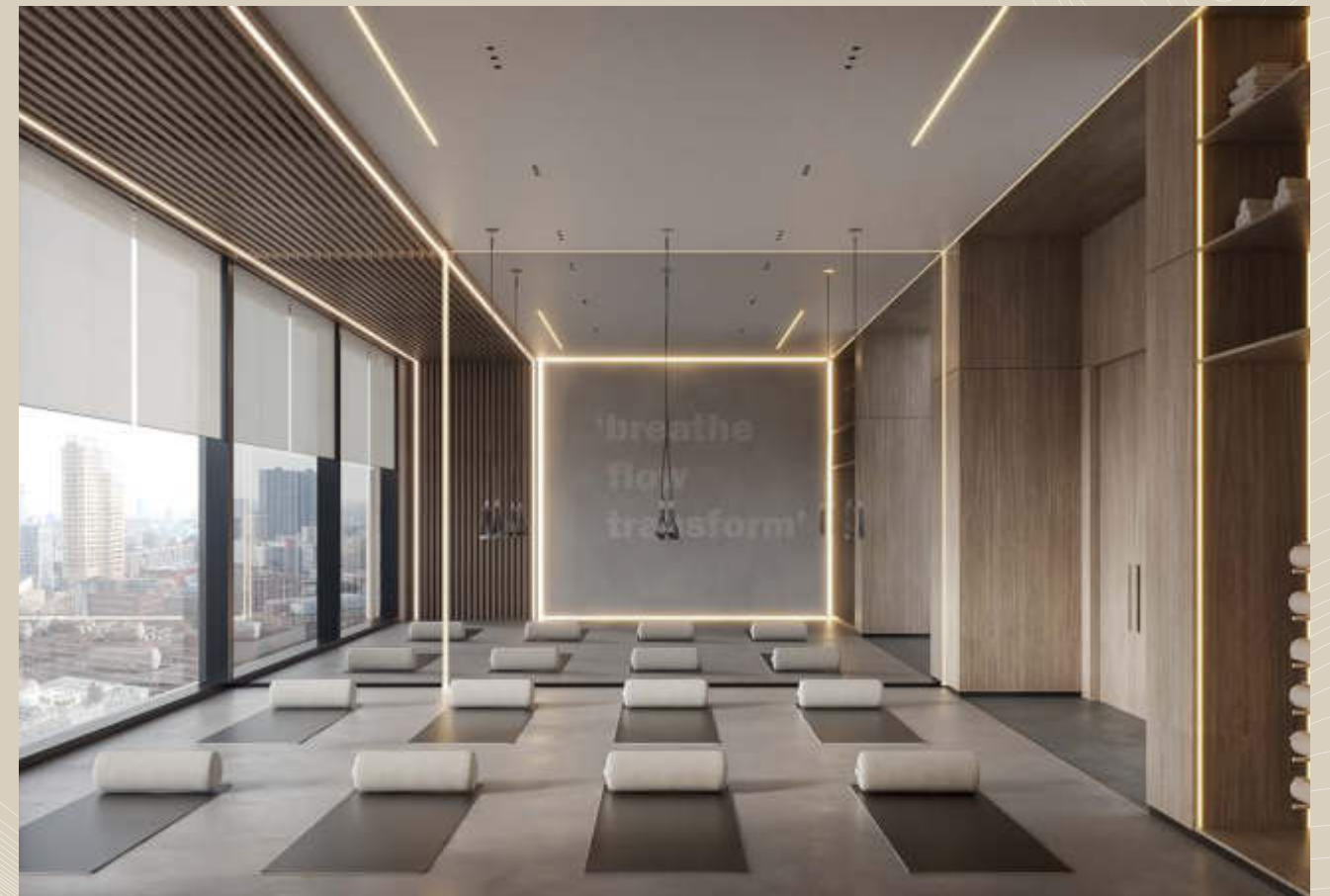





---

## Nature's Harmony Designed for you

At PARKWAY daily life unfolds, and nature blends seamlessly.

Each space features beautiful finishes that enhance the serene atmosphere, making every moment in your home a soothing experience.

The essence of peaceful living is reflected in every detail of PARKWAY, allowing you to relish a comforting environment and a residence like no other.





## Premium Materials

Every detail of PARKWAY reflects a commitment to nature-inspired design and quality.

From premium materials to sophisticated design elements, each residence speaks of unparalleled quality and craftsmanship.

Modern yet timeless, our spaces are made to inspire balanced living.





**+971 (4) 412-5000**

Affiliate  
managers



**Alevtina  
Kapustina**



**Svetlana  
Guseva**

## Office

Housebook Real Estate LCC

**Dubai Marina, office 2502-01, Dubai, UAE**

Company license: 1128098

[ae.housebook.deals](https://ae.housebook.deals)

[partner@housebook.ae](mailto:partner@housebook.ae)

