

Pelagia

BY BNW DEVELOPMENTS

AL MARJAN ISLAND



1BHK - TYPE A

1	Kitchen	2.9m x 2.7m
2	Living & Dining	4.2m x 5.9m
3	PWD Room	2.1m x 1.3m
4	Bedroom	4m x 4.4m
5	Bath	1.8m x 2.8m
6	Dress Room	2.1m x 2.7m
7	Balcony	8.5m x 1.6m

Suite Area	71.88 sq.m	773.71 sq.ft
Balcony Area	13.66 sq.m	147.04 sq.ft
Total Area	85.54 sq.m	920.74 sq.ft





1BHK - TYPE B

1	Kitchen	3.7m x 2.8m
2	Living & Dining	8.3m x 4.1m
3	PWD Room	1.7m x 1.5m
4	Bedroom	3.6m x 3.8m
5	Bath	1.8m x 2.7m
6	Dress Room	3.6m x 2.1m
7	Balcony 1	8.3m x 2.4m
8	Balcony 2	6.6m x 1.6m

Suite Area	84.93 sq.m	914.18 sq.ft
Balcony Area	29.98 sq.m	322.70 sq.ft
Total Area	114.91 sq.m	1236.88 sq.ft





1BHK - TYPE C

1	Kitchen	3.1m x 3.5m
2	Living & Dining	7m x 3.9m
3	PWD Room	1.8m x 1.3m
4	Bedroom	3.7m x 4.6m
5	Bath	1.8m x 2.8m
6	Dress Room	1.8m x 2.7m
7	Balcony	11.7m x 1.8m

Suite Area	73.36 sq.m	789.64 sq.ft
Balcony Area	18.73 sq.m	201.61 sq.ft
Total Area	92.09 sq.m	991.25 sq.ft





1BHK - TYPE D

1	Kitchen	2.6m x 2.7m
2	Living & Dining	3.9m x 7.1m
3	PWD Room	2m x 1.8m
4	Laundry	1m x 1m
5	Bedroom	3.3m x 3.9m
6	Bath	2.7m x 1.8m
7	Dress Room	2.6m x 3.6m
8	Balcony	5.8m x 1.5m

Suite Area	72.84 sq.m	784.04 sq.ft
Balcony Area	8.32 sq.m	89.56 sq.ft
Total Area	81.16 sq.m	873.60 sq.ft





1BHK - TYPE E

1	Kitchen	2.4m x 2.7m
2	Living & Dining	6.1m x 5.4m
3	PWD Room	2.1m x 1.3m
4	Bedroom	4m x 4.4m
5	Bath	1.8m x 2.8m
6	Dress Room	2.1m x 2.7m
7	Balcony 1	10.3m x 6m
8	Balcony 2	6.5m x 1.5m

Suite Area	71.72 sq.m	771.99 sq.ft
Balcony Area	58.82 sq.m	633.13 sq.ft
Total Area	130.54 sq.m	1405.12 sq.ft





1BHK - TYPE F

1	Kitchen	4.1m x 2.4m
2	Living & Dining	5.8m x 3.4m
3	PWD Room	1.7m x 1.5m
4	Bedroom	3.9m x 3.6m
5	Bath	2.8m x 1.7m
6	Dress Room	1.8m x 3.6m
7	Balcony	4.6m x 11.2m

Suite Area	62.65 sq.m	674.36 sq.ft
Balcony Area	44.4 sq.m	477.92 sq.ft
Total Area	107.05 sq.m	1152.28 sq.ft





2BHK - TYPE A

1	Kitchen	2.8m x 2.7m
2	Living & Dining	4.1m x 6m
3	PWD Room	1.9m x 1.6m
4	Laundry	2m x 1.6m
5	Bedroom 1	3.8m x 4.9m
6	Bath 1	2.4m x 2.5m
7	Dress Room 1	1.9m x 2.5m
8	Bedroom 2	4m x 4.1m
9	Bath 2	2.8m x 1.8m
10	Balcony	12.3m x 1.6m

Suite Area	107.09 sq.m	1152.71 sq.ft
Balcony Area	20.09 sq.m	216.25 sq.ft
Total Area	127.18 sq.m	1368.95 sq.ft





2 BHK - TYPE B

1	Kitchen	2.4m x 3.7m
2	Living & Dining	3.8m x 6.7m
3	PWD Room	2m x 1.3m
4	Bedroom 1	4.7m x 3.6m
5	Bath 1	2.8m x 1.8m
6	Dress Room 1	1.8m x 1.8m
7	Bedroom 2	4.7m x 3.2m
8	Bath 2	2.8m x 1.8m
9	Dress Room 2	2.4m x 1.9m
10	Balcony 1	11.4m x 1.6m
11	Balcony 2	1.4m x 9.6m

Suite Area	98.08 sq.m	1055.72 sq.ft
Balcony Area	33.88 sq.m	364.68 sq.ft
Total Area	131.96 sq.m	1420.41 sq.ft

Level 1



Key Plan



2 BHK - TYPE C

1	Kitchen	2.3m x 2.7m
2	Living & Dining	6.1m x 5.9m
3	PWD Room	2.1m x 1.4m
4	Bedroom 1	4.6m x 4.7m
5	Bath 1	2.4m x 1.6m
6	Dress Room 1	2.4m x 1.9m
7	Bedroom 2	3.2m x 3.4m
8	Bath 2	1.7m x 2.5m
9	Dress Room 2	2m x 2.5m
10	Balcony	18.2m x 2.1m

Suite Area	97.21 sq.m	1046.36 sq.ft
Balcony Area	39.07 sq.m	420.55 sq.ft
Total Area	136.28 sq.m	1466.91 sq.ft

Level 1





2 BHK - TYPE D

1	Kitchen	2.3m x 2.7m
2	Living & Dining	6.1m x 5.9m
3	PWD Room	2.1m x 1.4m
4	Bedroom 1	4.6m x 4.7m
5	Bath 1	2.4m x 1.6m
6	Dress Room 1	2.4m x 1.9m
7	Bedroom 2	3.2m x 3.4m
8	Bath 2	1.7m x 2.5m
9	Dress Room 2	2m x 2.5m
10	Balcony	18.2m x 2.1m

Suite Area	107.85 sq.m	1160.89 sq.ft
Balcony Area	186.19 sq.m	2004.13 sq.ft
Total Area	294.04 sq.m	3165.02 sq.ft

Level 1



Key Plan



2 BHK - TYPE E

1	Kitchen	3.1m x 5.1m
2	Living & Dining	4m x 8.2m
3	PWD Room	1.3m x 2.6m
4	Bedroom 1	5.6m x 3.6m
5	Bath 1	1.8m x 2.6m
6	Dress Room 1	1.8m x 2.2m
7	Bedroom 2	3.7m x 3.4m
8	Bath 2	1.8m x 2.6m
9	Dress Room 2	1.7m x 2.6m
10	Maid Room	3.6m x 2.6m
11	Bath	1.6m x 1.5m
12	Balcony 1	1.5m x 11.9m
13	Balcony 2	11m x 1.7m
14	Balcony 3	4.7m x 2.3m

Suite Area	122.69 sq.m	1320.62 sq.ft
Balcony Area	47.23 sq.m	508.38 sq.ft
Total Area	169.92 sq.m	1829.00 sq.ft

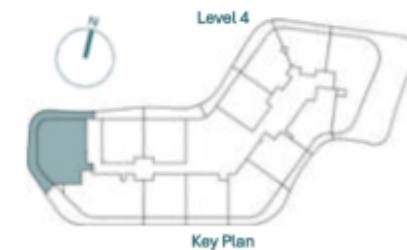



2BHK - TYPE F

1	Kitchen	3.4m x 2.5m
2	Living & Dining	6.9m x 7.4m
3	PWD Room	2.3m x 1.7m
4	Bedroom 1	4m x 4.4m
5	Bath 1	1.8m x 2.8m
6	Dress Room 1	2.1m x 4.1m
7	Bedroom 2	4.3m x 3.4m
8	Bath 2	2.6m x 1.7m
9	Dress Room 2	1.6m x 1.7m
10	Maid Room	2.4m x 2.2m
11	Bath	1.8m x 2.2m
12	Balcony 1	12.3m x 1.4m
13	Balcony 2	9.2m x 2.5m

Suite Area	120.85 sq.m	1300.82 sq.ft
Balcony Area	46.29 sq.m	498.26 sq.ft
Total Area	167.14 sq.m	1799.08 sq.ft





2BHK - TYPE G

1	Kitchen	2.5m x 2.7m
2	Living & Dining	6.5m x 6.4m
3	PWD Room	2m x 1.3m
4	Laundry	1.6m x 1.3m
5	Bedroom 1	4m x 4.5m
6	Bath 1	1.8m x 2.7m
7	Dress Room 1	2.1m x 4m
8	Bedroom 2	4.1m x 3.3m
9	Bath 2	1.8m x 2.6m
10	Dress Room 2	2.2m x 2.6m
11	Balcony 1	9.7m x 1.8m
12	Balcony 2	11m x 2.1m

Suite Area	114.21 sq.m	1229.35 sq.ft
Balcony Area	37 sq.m	398.26 sq.ft
Total Area	151.21 sq.m	1627.61 sq.ft





2BHK - TYPE H

1	Kitchen	3m x 2.7m
2	Living & Dining	4.2m x 6m
3	PWD Room	2.1m x 1.3m
4	Bedroom 1	3.6m x 5.8m
5	Bath 1	2.5m x 1.8m
6	Bedroom 2	3.8m x 4.5m
7	Bath 2	2.6m x 1.8m
8	Laundry	2.1m x .9m
9	Balcony	12m x 2.3m

Suite Area	91.17 sq.m	981.35 sq.ft
Balcony Area	22.8 sq.m	245.42 sq.ft
Total Area	113.97 sq.m	1226.76 sq.ft





2BHK - TYPE I

1	Kitchen	2.2m x 3.7m
2	Living & Dining	4.3m x 10.2m
3	PWD Room	1.4m x 1.6m
4	Bedroom 1	6.3m x 5.3m
5	Bath 1	2.9m x 2.5m
6	Bedroom 2	4.4m x 4m
7	Bath 2	2.7m x 3m
8	Maid Room	2.3m x 2.3m
9	Bath	2.3m x 1.5m
10	Balcony 1	16m x 9.9m
11	Balcony 2	1.4m x 7.5m

Suite Area	125.48 sq.m	1350.66 sq.ft
Balcony Area	134.87 sq.m	1451.73 sq.ft
Total Area	260.35 sq.m	2802.38 sq.ft

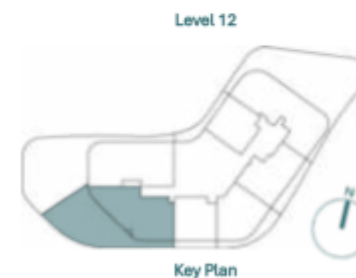



2BHK - TYPE J

1	Kitchen	4.4m x 2.7m
2	Living & Dining	6.6m x 6.1m
3	PWD Room	2.1m x 1.5m
4	Bedroom 1	4.6m x 3.8m
5	Bath 1	2.8m x 2.7m
6	Dress Room 1	1.7m x 2.7m
7	Bedroom 2	3.4m x 4.7m
8	Bath 2	2.1m x 2.7m
9	Dress Room 2	2.1m x 1.9m
10	Maid Room	3m x 2.1m
11	Bath	1.5m x 2.1m
12	Laundry	1.8m x 1.5m
13	Balcony 1	17.2m x 1.5m
14	Balcony 2	13.1m x 14.5m

Suite Area	146.86 sq.m	1580.79 sq.ft
Balcony Area	187.84 sq.m	2021.89 sq.ft
Total Area	334.7 sq.m	3602.68 sq.ft

Level 12



Key Plan



3BHK - TYPE A

1	Kitchen	2.4m x 3.6m
2	Living & Dining	7.6m x 6.8m
3	PWD Room	1.5m x 1.8m
4	Bedroom 1	5.3m x 4.3m
5	Bath 1	3.4m x 2m
6	Dress Room 1	1.8m x 2.6m
7	Bedroom 2	3.6m x 4.9m
8	Bath 2	1.7m x 2.8m
9	Bedroom 3	3.4m x 4.4m
10	Bath 3	1.6m x 2.6m
11	Maid Room	1.8m x 2.6m
12	Bath	1.8m x 1.5m
13	Balcony 1	1.6m x 11.3m
14	Balcony 2	23.2m x 1.6m
15	Balcony 3	2m x 4.8m

Suite Area	158.26 sq.m	1703.50 sq.ft
Balcony Area	63.01 sq.m	678.23 sq.ft
Total Area	221.27 sq.m	2381.73 sq.ft

Level 1

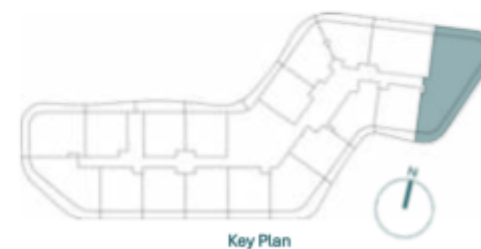

3BHK - TYPE B



1	Kitchen	2.6m x 3.4m
2	Living & Dining	6.1m x 7.2m
3	PWD Room	1.7m x 1.7m
4	Bedroom 1	6m x 4.3m
5	Bath 1	2.8m x 2m
6	Dress Room 1	1.6m x 2m
7	Bedroom 2	4.5m x 3.3m
8	Bath 2	2.8m x 1.8m
9	Dress Room 2	1.6m x 3.5m
10	Bedroom 3	3.4m x 4.2m
11	Bath 3	2.1m x 2.9m
12	Dress Room 3	2.1m x 1.7m
13	Maid Room	2.4m x 2.1m
14	Bath	2.4m x 1.5m
15	Balcony 1	1.3m x 7.4m
16	Balcony 2	22.3m x 7.6m
17	Balcony 3	1m x 9.2m

Suite Area	160.94 sq.m	1732.34 sq.ft
Balcony Area	156.06 sq.m	1679.82 sq.ft
Total Area	317 sq.m	3412.16 sq.ft



Level 4



Key Plan

3BHK - TYPE C

1	Kitchen	2.7m x 2.4m
2	Living & Dining	7.4m x 4.4m
3	PWD Room	1.3m x 1.7m
4	Bedroom 1	4.7m x 4.3m
5	Bath 1	2.9m x 2.5m
6	Dress Room 1	1.7m x 2.7m
7	Bedroom 2	3.3m x 3.8m
8	Bath 2	1.6m x 2.7m
9	Dress Room 2	1.6m x 2.7m
10	Bedroom 3	3.5m x 3.2m
11	Bath 3	2.5m x 1.8m
12	Dress Room 3	1.3m x 1.8m
13	Maid Room	2.6m x 3m
14	Bath	1.3m x 2m
15	Balcony 1	22.8m x 6.5m
16	Balcony 2	1.3m x 10.5m

Suite Area	138.51 sq.m	1490.91 sq.ft
Balcony Area	174.82 sq.m	1881.75 sq.ft
Total Area	313.33 sq.m	3372.66 sq.ft



3BHK - TYPE D

1	Kitchen	3m x 3.2m
2	Living & Dining	7.7m x 5.2m
3	PWD Room	2.2m x 1.6m
4	Bedroom 1	4.4m x 3.7m
5	Bath 1	3.9m x 2.4m
6	Dress Room 1	2.7m x 3.1m
7	Bedroom 2	3.7m x 4m
8	Bath 2	1.7m x 2.8m
9	Bedroom 3	3.7m x 3.7m
10	Bath 3	1.7m x 2.5m
11	Maid Room	2.1m x 2.1m
12	Bath	1.5m x 1.5m
13	Laundry	0.8m x 1.9m
14	Balcony 1	12.1m x 3m
15	Balcony 2	1.3m x 22.4m

Suite Area	156.76 sq.m	1687.35 sq.ft
Balcony Area	70.13 sq.m	754.87 sq.ft
Total Area	226.89 sq.m	2442.22 sq.ft



3BHK - TYPE E

1	Kitchen	3.1m x 2.4m
2	Living & Dining	7.2m x 7.6m
3	PWD Room	1.7m x 1.8m
4	Bedroom 1	4.1m x 4.1m
5	Bath 1	3m x 2.3m
6	Dress Room 1	3m x 1.7m
7	Bedroom 2	3.7m x 5m
8	Bath 2	2.6m x 1.6m
9	Bedroom 3	3.3m x 4.1m
10	Bath 3	1.8m x 3m
11	Maid Room	2m x 2.3m
12	Bath	2m x 1.4m
13	Laundry	1.9m x 1.2m
14	Balcony 1	1.2m x 9.4m
15	Balcony 2	21.9m x 12.9m
16	Balcony 3	1.4m x 7.9m

Suite Area	155.28 sq.m	1671.42 sq.ft
Balcony Area	217.72 sq.m	2343.52 sq.ft
Total Area	373 sq.m	4014.94 sq.ft



PENTHOUSE 1

1	Kitchen	4.3m x 3.8m
2	Living & Dining	7.5m x 10.7m
3	PWD Room	1.8m x 2m
4	Wash Room	1.8m x 1.6m
5	Bedroom 1	7.8m x 9.5m
6	Bath 1	3.4m x 3.3m
7	Dress Room 1	3.9m x 3.3m
8	Bedroom 2	4.4m x 5m
9	Bath 2	2.8m x 2.3m
10	Dress Room 2	2.8m x 2.6m
11	Bedroom 3	4.4m x 5m
12	Bath 3	2.8m x 2.3m
13	Dress Room 3	2.8m x 2.6m
14	Bedroom 4	8.6m x 8.3m
15	Bath 4	2.9m x 3.3m
16	Dress Room 4	2.6m x 3.3m
17	Maid Room	2.5m x 2.1m
18	Bath	2.5m x 1.5m
19	Balcony 1	1.4m x 26.2m
20	Balcony 2	17.4m x 5.1m
21	Balcony 3	1.4m x 15.2m

Suite Area	381.58 sq.m	4107.29 sq.ft
Balcony Area	152.34 sq.m	1639.77 sq.ft
Total Area	533.92 sq.m	5747.07 sq.ft



PENTHOUSE 2

1	Kitchen	4.6m x 4.1m
2	Living & Dining	7.8m x 11.7m
3	PWD Room	1.8m x 2m
4	Wash Room	1.8m x 1.9m
5	Bedroom 1	8.7m x 5.5m
6	Bath 1	4.5m x 2.7m
7	Dress Room 1	3m x 4.5m
8	Bedroom 2	4.5m x 3.6m
9	Bath 2	2.8m x 1.7m
10	Dress Room 2	1.6m x 1.7m
11	Bedroom 3	4.5m x 4m
12	Bath 3	2.8m x 1.6m
13	Dress Room 3	1.6m x 1.8m
14	Bedroom 4	8.8m x 4.7m
15	Bath 4	3m x 2.4m
16	Dress Room 4	3m x 2.2m
17	Maid Room	2.2m x 2.4m
18	Bath	2.2m x 1.5m
19	Balcony 1	1m x 16.5m
20	Balcony 2	20.7m x 4m
21	Balcony 3	2.4m x 25.2m

Suite Area	353.2 sq.m	3801.81 sq.ft
Balcony Area	123.6 sq.m	1330.42 sq.ft
Total Area	476.8 sq.m	5132.23 sq.ft



housebook Real Estate Company
since 2012 in the UAE

+971 (4) 412-5007

Managers of partnerships



Alevtina Kapustina



Svetlana Guseva

Office

Housebook Real Estate LCC

Dubai Marina, office 2502-01, Dubai, UAE

Company license: 1128098

ae.housebook.deals

partner@housebook.ae

